

Bryony Road, London, W12 0SR

Asking Price £745,000 Freehold



KEY FEATURES:

- NO UPPER CHAIN
- OFF ROAD CAR PARKING
- DETACHED GARAGE TO REAR
- EXTENDED TO THE REAR
- THREE BEDROOMS
- REFITTED KITCHEN
- OPEN PLAN LIVING
- UPVC DOUBLE GLAZING
- EXCELLENT TRANSPORT LINKS

*** A CASHBACK OF £250 IS AVAILABLE ON COMPLETION IF PURCHASED THROUGH US AT CHURCHILL & MATHESONS, call to view***

A well-presented THREE BEDROOM TERRACED HOUSE with LARGE rear garden with separate patio area.

This property comprises of Entrance Hall, SPACIOUS OPEN PLAN bay fronted kitchen/lounge with ample storage space, fitted kitchen with modern wall and base units and tiled splashback, door leading to the well-kept REAR GARDEN with separate patio area. On the first floor there is three bedrooms and bathroom.

Further benefits are the property has a detached garage and double glazing throughout.

Bryony Road is located close to local shops, schools and Wormholt Park is just a short walk away. Local transport links include bus routes to Hammersmith and East Acton. Shepherds Bush Overground Station for trains to Milton Keynes, Shepherds Bush Underground Station (Central Line - Zone 2) and Wood Lane Station (Circle Line & Hammersmith & Fulham Line - Zone 2) are all around 15 mins walk away offering easy access into Central London and the West End.

Local Authority London Borough of Hammersmith & Fulham. Council Tax Band D.

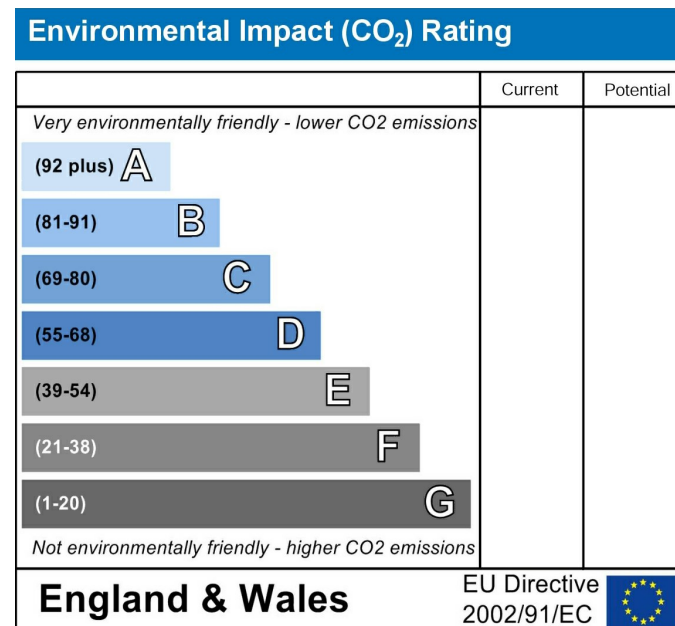
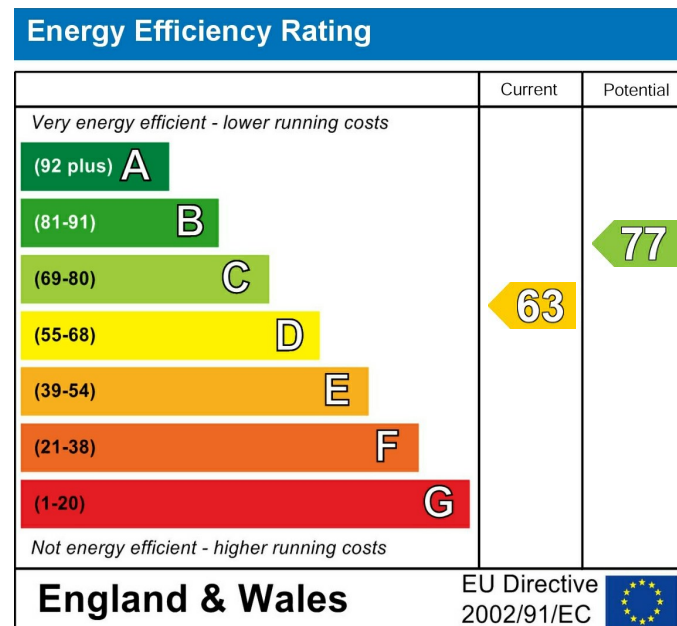
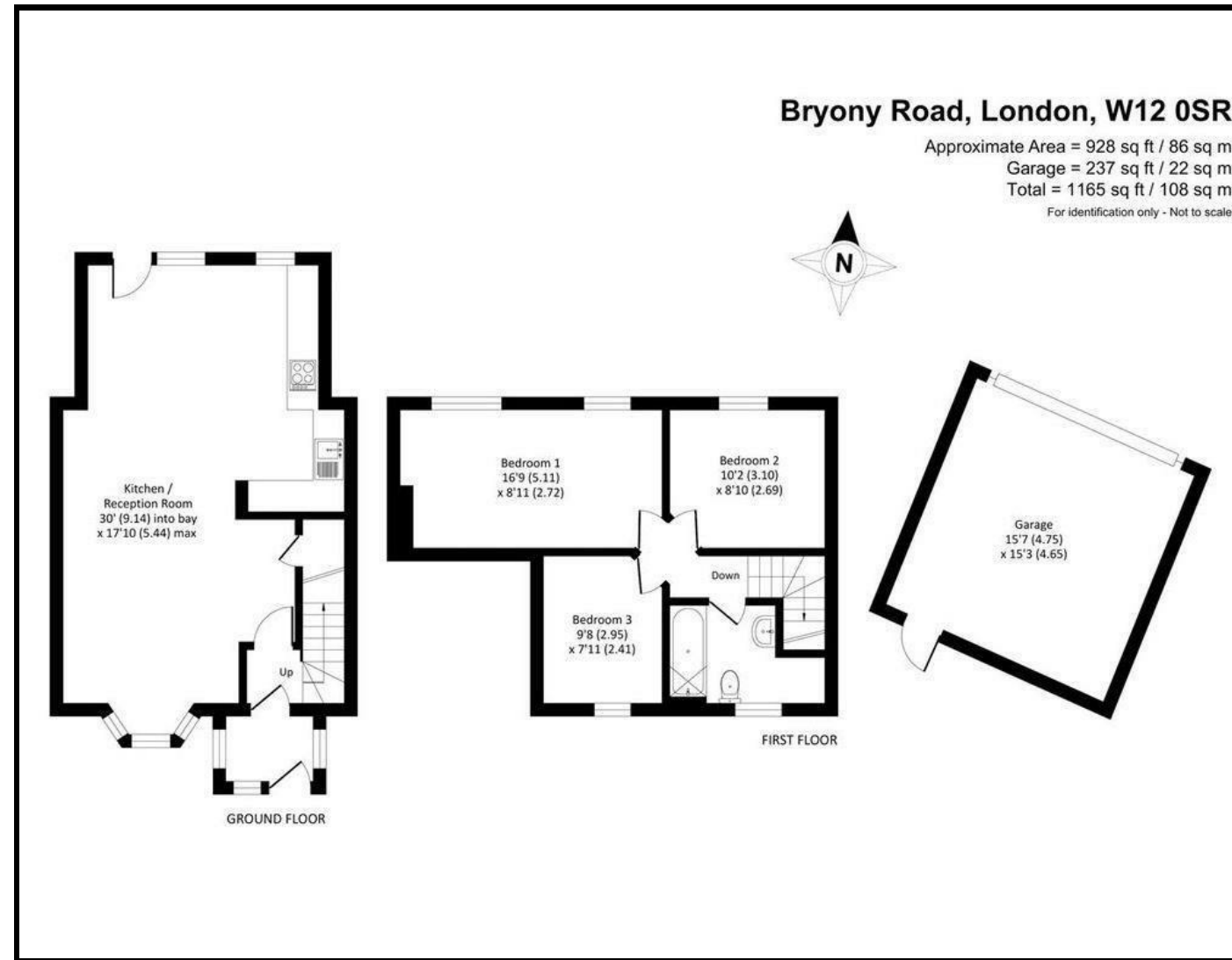

Whilst every effort is made to give a fair description, the accuracy of these particulars is not guaranteed, neither do they constitute an offer or contract.

CHURCHILL & MATHESONS ESTATE AGENTS have not tested any apparatus, equipment, fitting or services and so cannot verify that they are in working order. The buyer is advised to obtain verification from their solicitor or surveyor. Measurements are correct to within +/- 6 A sonic tape is used. None of the statements contained in these particulars or any of our properties are to be relied upon as a representation of fact.